

# Preserving Digital Design Files

complicated, but not impossible

Aliza Leventhal  
Librarian/Archivist - Sasaki Associates

[aleventhal@sasaki.com](mailto:aleventhal@sasaki.com)

 @alizaleventhal

Microsoft Suite  
Google Docs/Sheets/Slides  
Smart Sheets  
Adobe Suite  
Autodesk AutoCAD  
Autodesk 3DsMax  
Autodesk Revit  
Sketchup  
Rhino  
Piranesi  
FormZ  
V-Ray (for various programs)  
Maxwell (for various programs)  
Lumion (for various programs)  
ESRI ArcScene  
ESRI ArcMap  
Rhino Grasshopper  
Rhino Terrain  
Ecotect  
GoogleEarthPro  
+ in-house built tools



Autodesk AutoCAD Civil 3D - Corridor.dwg

Home Insert Annotate Modify Analyze View Manage Output Survey Autodesk 360 Help Express Tools Performance Section Editor

Select a Baseline: Main Road | Select a Station: 42+25.00

Apply to a Station Range | Update Corridor | Add a Region | Station Tracker | Zoom to Extents | View/Edit Options | Viewport Configuration | Display Objects | View Tools

Parameter Editor | Change Assembly | Corridor Edit Tools

General | Baselines & Offsets | Station Selection

TOOLSPACE

Active Drawing View

- Corridor
  - Points
  - Point Groups
  - Point Clouds
  - Surfaces
  - Alignments
  - Sites
  - Catchments
  - Pipe Networks
  - Pressure Networks
  - Corridors
    - Road Improvements
  - Assemblies
  - Intersections
  - Survey
  - View Frame Groups
  - Data Shortcuts
  - Surfaces
  - Alignments
  - Pipe Networks
  - Pressure Networks
  - View Frame Groups

Name	Alignment	Profile	Frequency
1	Main Road	FISH POND R	Proposed Car

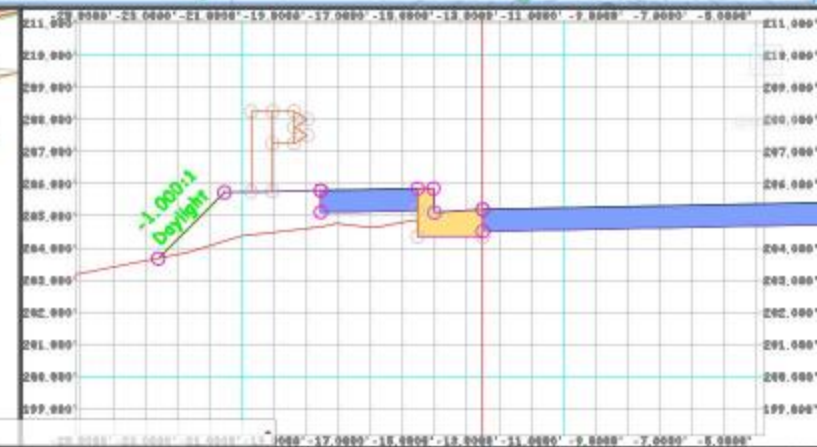
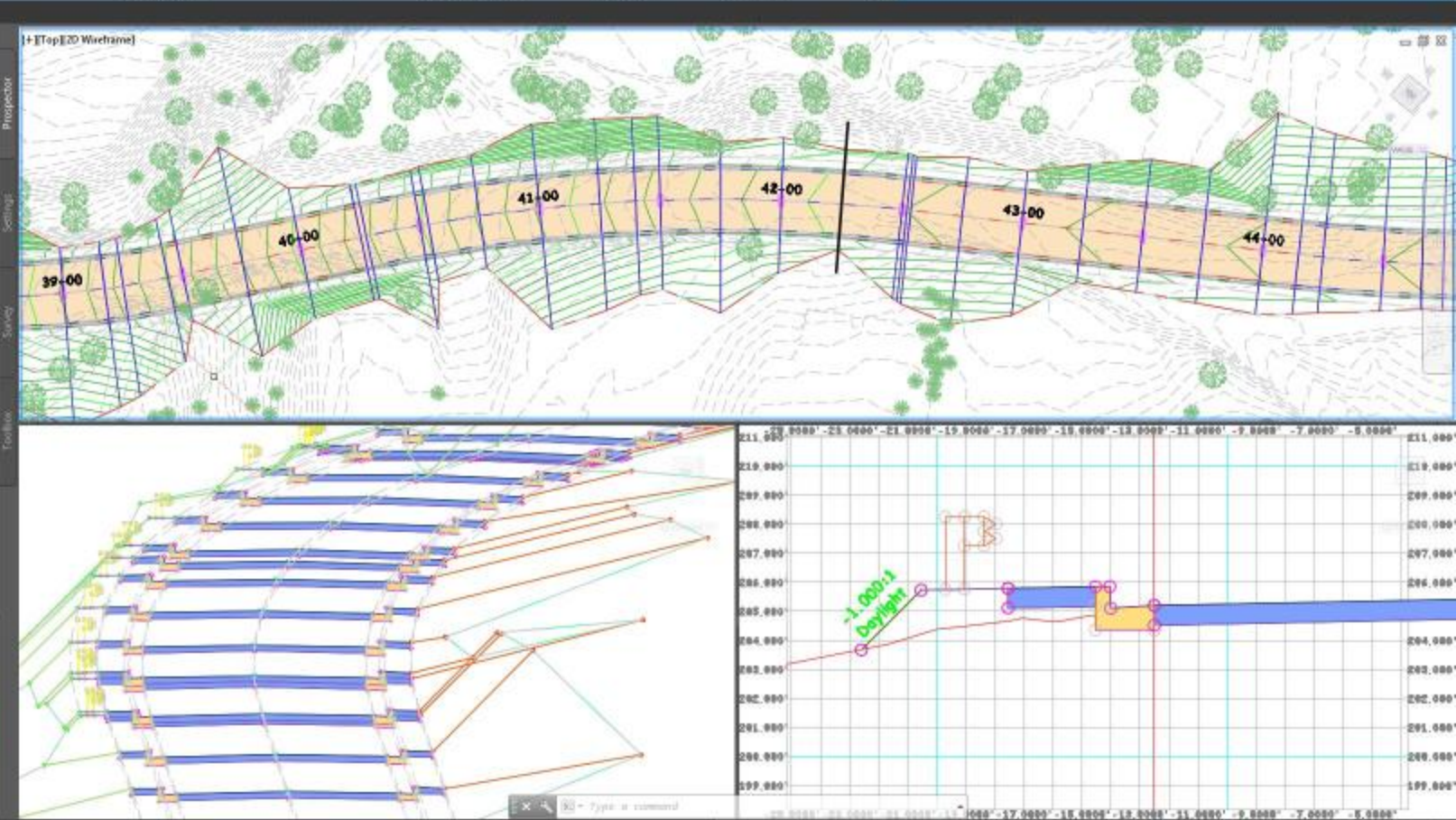



TOOLSPACE

Active Drawing View

- Corridor
  - Points
  - Point Groups
  - Point Clouds
  - Surfaces
  - Alignments
  - Sites
  - Catchments
  - Pipe Networks
  - Pressure Networks
  - Corridors
    - Road Improvements
  - Assemblies
  - Intersections
  - Survey
  - View Frame Groups
  - Data Shortcuts
  - Surfaces
  - Alignments
  - Pipe Networks
  - Pressure Networks
  - View Frame Groups

Name	Alignment	Profile	Frequency
1	Main Road	FISH POND R	Proposed

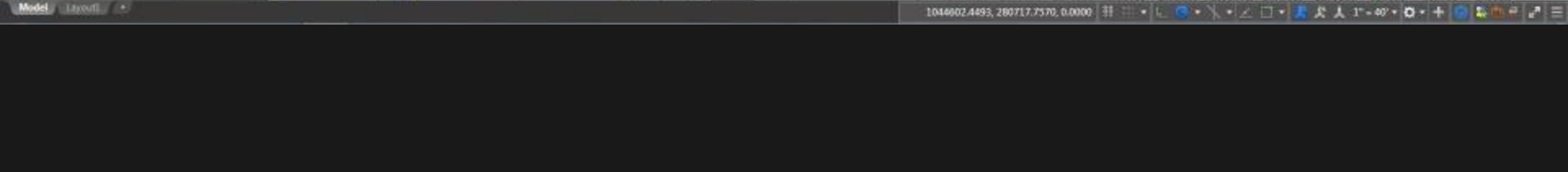
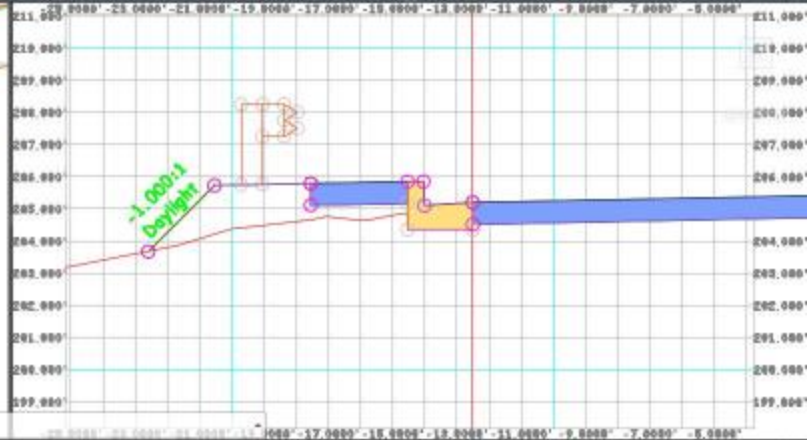
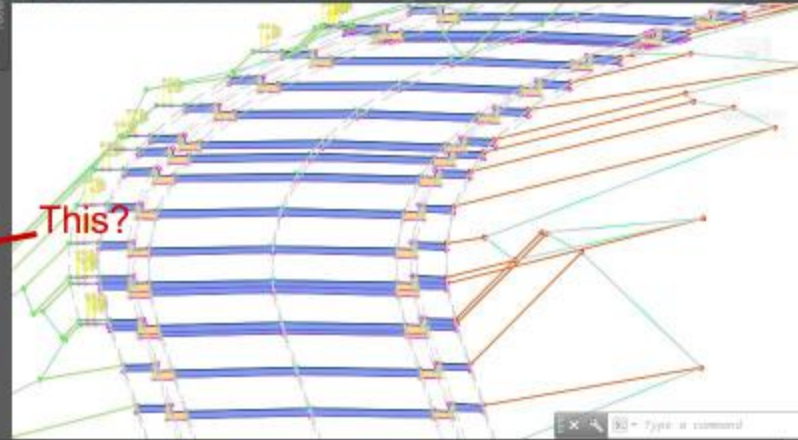
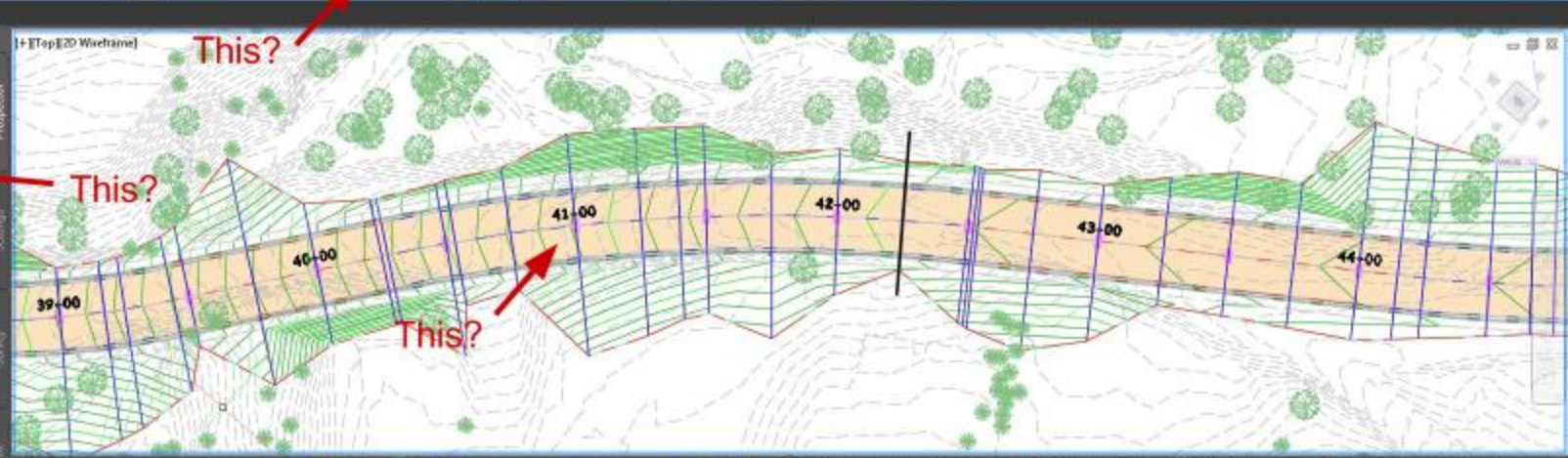

















**LOTAR**

LONG TERM ARCHIVING AND RETRIEVAL





 Drawing3.dwg	2/1/2010 1:56 PM	AutoCAD Drawing
 G-CV-csht.bak	10/5/2011 10:38 A...	BAK File
 G-CV-csht.dwg	4/13/2012 2:35 PM	AutoCAD Drawing
 G-KP-aerial.dwg	2/1/2010 1:34 PM	AutoCAD Drawing
 LAND - Shortcut	8/17/2011 10:37 A...	Shortcut
 parks_logo.gif	6/10/2009 10:24 PM	GIF image
 plot.log	2/1/2010 2:13 PM	Text Document
 Projects_15a.jpg	1/20/2010 3:32 PM	JPG File
 SA-1117.bak	2/1/2010 9:10 AM	BAK File
 SA-1117.dwg	2/1/2010 1:26 PM	AutoCAD Drawing
 z-SUB-GI001 COVER SHEET (1).pdf	2/1/2010 2:13 PM	Adobe Acrobat D...
 z-SUB-GI001.bak	2/1/2010 4:27 PM	BAK File
 z-SUB-GI001.dwg	2/1/2010 4:39 PM	AutoCAD Drawing



## MassCOPAR

(Massachusetts Committee for the  
Preservation of Architectural Records)

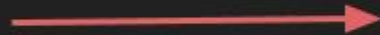

## SAA Architectural Records Roundtable + CAD/BIM Taskforce

(Computer-Aided-Design / Building  
Information Modelling)

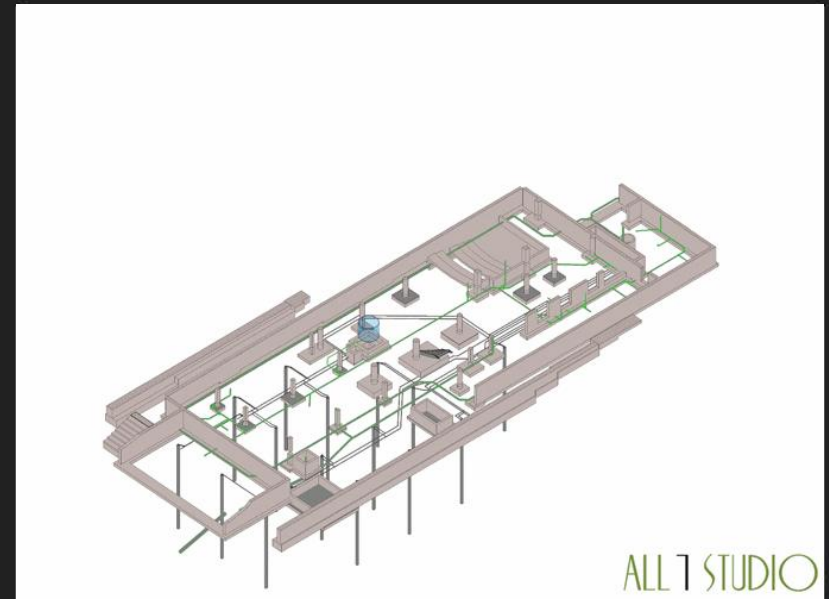

ALL 1 STUDIO

© <http://all1studio.com/wp-content/uploads/2013/10/BIM.gif>



## Software Library: MS-DOS Games

Software for MS-DOS machines that represent entertainment and games. The collection includes action, strategy, adventure and other unique genres of game and entertainment software. Through the use of the EMU DOSBOX in 300K.

About Collection

Sort by: RELEVANCE · VIEWS · TITLE · DATE ARCHIVED · CREATOR

<p><b>The Oregon Trail</b> by GIGAWATT</p> <p>1.8k 1.2k 145</p>	<p><b>Prince of Persia</b> by GIGAWATT</p> <p>336.12k 700 22</p>	<p><b>Wolfenstein 3D</b> by GIGAWATT</p> <p>219.44k 200 12</p>	<p><b>Pac-Man</b> by GIGAWATT</p> <p>42k 410 113 1</p>	<p><b>Oregon Trail Deluxe, The</b> by GIGAWATT</p> <p>432.44k 700 75</p>
<p><b>SimCity</b> by Maxis Software Inc.</p> <p>860.64k 300 11</p>	<p><b>Super Street Fighter II</b> by Capcom (Dev.)</p> <p>207.42k 700 11</p>	<p><b>4D Prince of Persia</b> by GIGAWATT</p> <p>219.23k 200 12</p>	<p><b>Prohezonik 2</b> by GIGAWATT</p> <p>24.146k 100 5</p>	<p><b>Stunts</b> by Core Design Software, Inc.</p> <p>102.113k 200 5</p>